



# Alila Elementary School

The Earlimart School District, located in California's Central Valley, serves a socioeconomically disadvantaged community where resources are limited but educational needs continue to grow. At Alila Elementary School, rising enrollment created an urgent demand for additional classroom space, especially to accommodate transitional kindergarten (TK) and expanded kindergarten programs.

Enviroplex partnered with the district to deliver a comprehensive solution that went beyond traditional classroom construction. The project included the installation of five high-quality modular classroom buildings—four 72'x40' kindergarten classrooms and one 36'x40' TK classroom—strategically placed to fit within spatial constraints on campus.

Each building was designed with early learners in mind, featuring age-appropriate restrooms, safety-conscious layouts, and energy-efficient systems. In addition to the classrooms, the project also included extensive landscaping and the installation of a new playground situated directly in front of the buildings. These enhancements transformed not just the school site but the daily experience of students and teachers.

This project was particularly meaningful due to the surrounding area's extreme poverty. The new facilities brought visible excitement and pride to the campus community. The district celebrated the project with a ribbon-cutting ceremony and dedication both at the start and completion of construction—underscoring the significance of this investment in local children's futures.

Despite challenges with site logistics and timelines, Enviroplex worked hand-in-hand with district and construction partners to ensure on-time delivery and successful execution. The result is a lasting impact on a school that now has the infrastructure to grow, engage, and inspire its youngest learners.



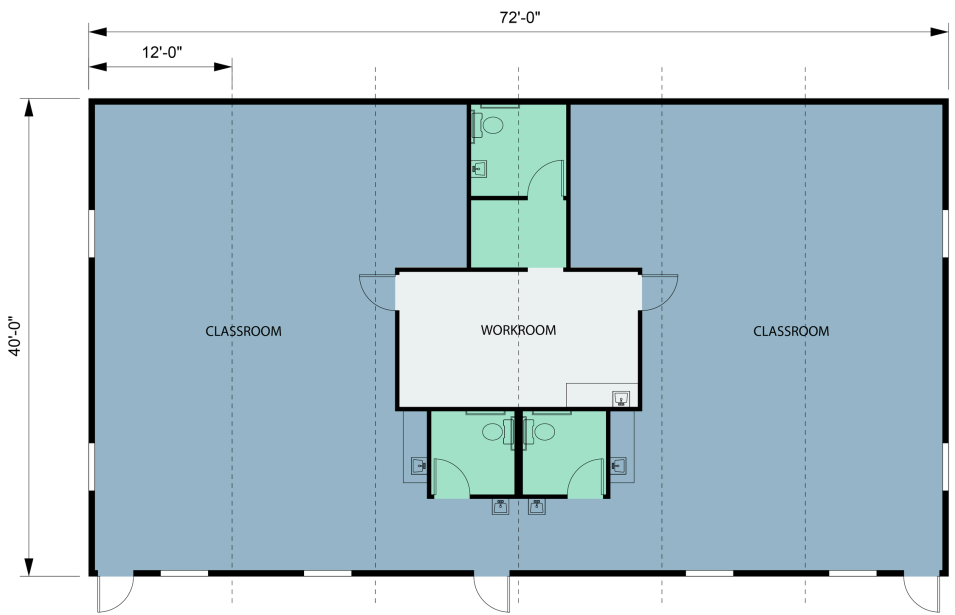
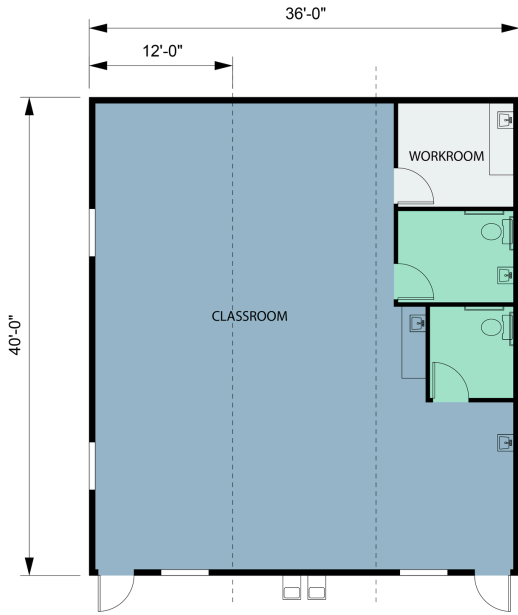

## Key Building Features

- Modular construction
- Age-appropriate amenities for TK and Kindergarten students
- Energy-efficient systems
- Custom-designed early education layouts
- Landscaping and integrated playground installation



## Project Scope and Size

- Four 72'x40' modular kindergarten classrooms
- One 36'x40' modular transitional kindergarten classroom
- Total of five buildings